

PARTS LIST						
ITEM	QTY	PART NO.	PART DESCRIPTION	LENGTH	UNIT WT.	NET WT.
1	1	X-SOCX6	6" STANDOFF CROSSOVER WELDMENT		9.97	9.97
2	2	V-CLAMP	LARGE V-CLAMP	8 21/32 in	5.55	11.09
3	8	G5806	5/8" x 6" HDG HEX BOLT GR5 FULL THREAD	6 in	0.62	4.94
4	8	G58FW	5/8" HDG USS FLATWASHER	1/8 in	0.07	0.56
5	8	G58LW	5/8" HDG LOCKWASHER		0.03	0.21
6	8	G58NUT	5/8" HDG HEAVY 2H HEX NUT		0.13	1.04
					TOTAL WT. #	27.81

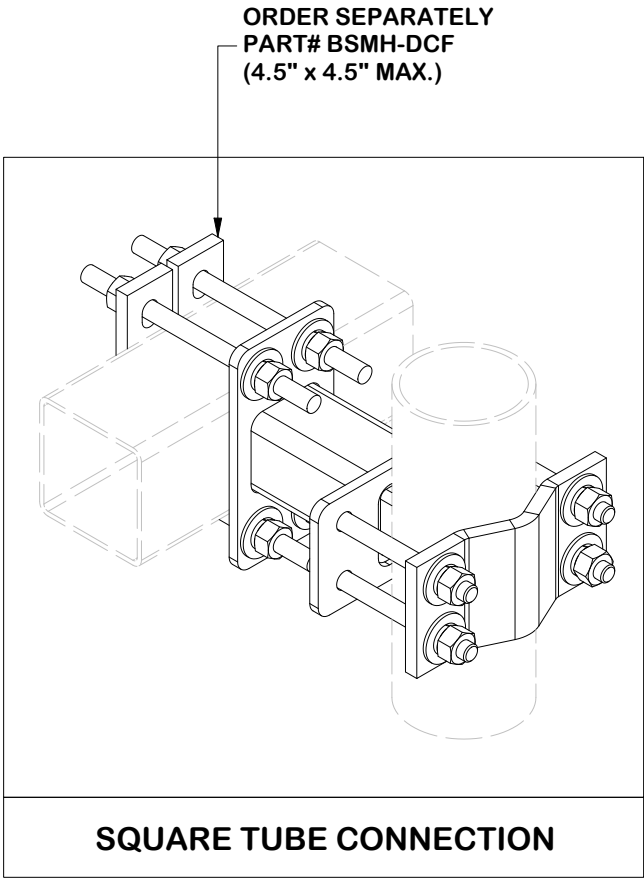
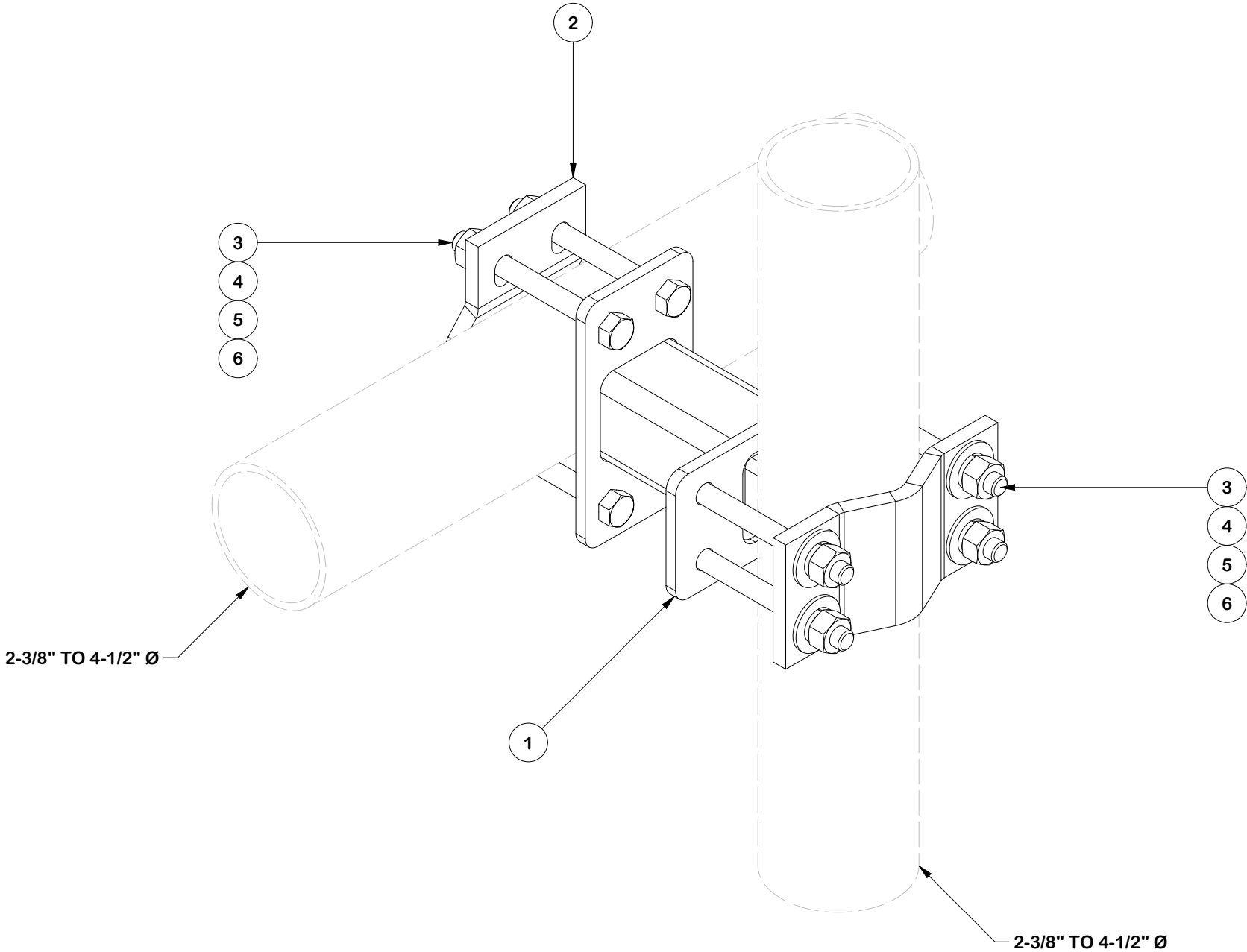

FINISH:
HOT DIP GALVANIZED.

TOLERANCE NOTES

TOLERANCES ON DIMENSIONS, UNLESS OTHERWISE NOTED ARE:
SAWED, SHEARED AND GAS CUT EDGES (± 0.030 ")
DRILLED AND GAS CUT HOLES (± 0.030 ") - NO CONING OF HOLES
LASER CUT EDGES AND HOLES (± 0.010 ") - NO CONING OF HOLES
BENDS AND ANGLES ARE $\pm 1/2$ DEGREE
ALL OTHER MACHINING (± 0.030 ")
ALL OTHER ASSEMBLY (± 0.060 ")

PROPRIETARY NOTE:
THE DATA AND TECHNIQUES CONTAINED IN THIS DRAWING ARE PROPRIETARY INFORMATION OF VALMONT INDUSTRIES AND CONSIDERED A TRADE SECRET. ANY USE OR DISCLOSURE WITHOUT THE CONSENT OF VALMONT INDUSTRIES IS STRICTLY PROHIBITED.

DESCRIPTION			
6" UNIVERSAL STANDOFF CROSSOVER KIT			

CPD NO.		DRAWN BY	ENG. APPROVAL
		CMFL 6/22/2023	6/28/2023
CLASS	SUB	DRAWING USAGE	CHECKED BY
87	02	CUSTOMER	JET 6/28/2023

<div><div>SITE PRO1</div><div>A valmont COMPANY</div></div>		Engineering Support Team: 1-888-753-7446
PART NO.		SOCX6-U
DWG. NO.		SOCX6-U